

**MOORING PLAN JETTY 15
<10,000 SDWT VESSELS**

BOLLARD	BOLLARD CAPACITY	TYPE LINE
15-B01	500 kN	
15-B02	500 kN	
15-B03	500 kN	BOWLINE
15-B04	500 kN	BOWLINE
15-B05	500 kN	
15-B06	500 kN	
15-B07	500 kN	STERNLINE
15-B08	500 kN	STERNLINE
LOWER BOLLARDS	300 kN	

NOTES:

- NO MIXED MOORING
- NO MORE THAN 2 LINES PER BOLLARD
- MINIMUM MOORING REQUIREMENTS:
 - SHIPS < 10,000 DWT: 2 HEAD- AND STERNLINES, 2 SPRINGLINES FWD AND AFT
 - SHIPS < 25,000 DWT: 3 HEAD- AND STERNLINES, 2 SPRINGLINES FWD AND AFT
 - SHIPS > 25,000 DWT: 4 HEAD- AND STERNLINES, 2 SPRINGLINES FWD AND AFT

EERSTE PETROLEUMHAVEN

LOA - 90m

15.B08 15.B07 15.B06 15.B05

JETTY 15

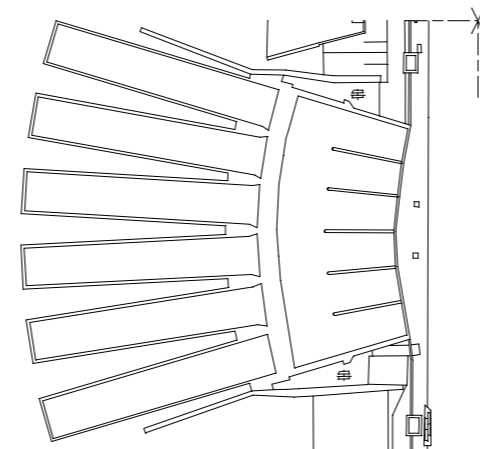

VULSTEGER

WEG 26

WEG 26

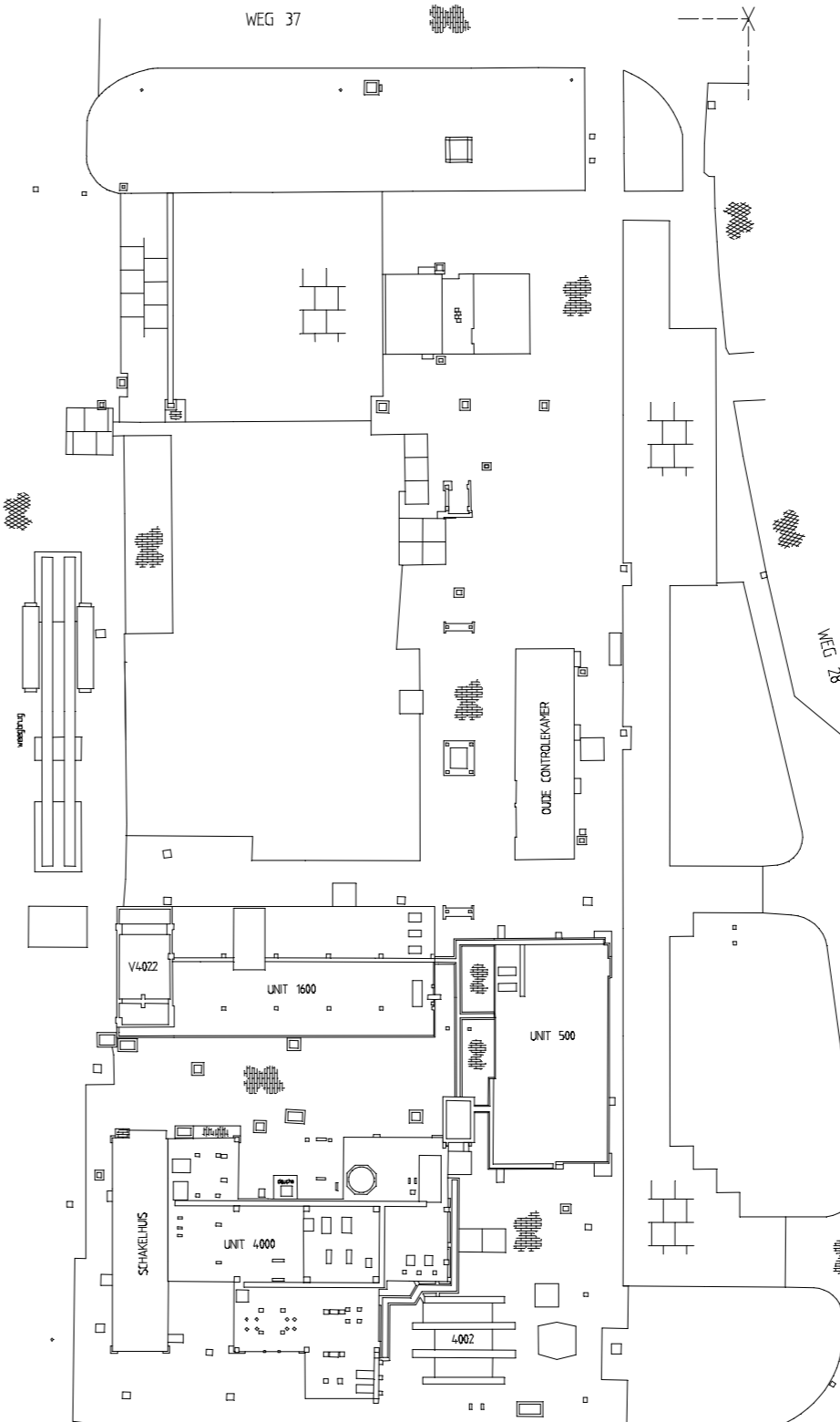

WEG 37

WEG 35

CF 1

WEG 28

WEG 28

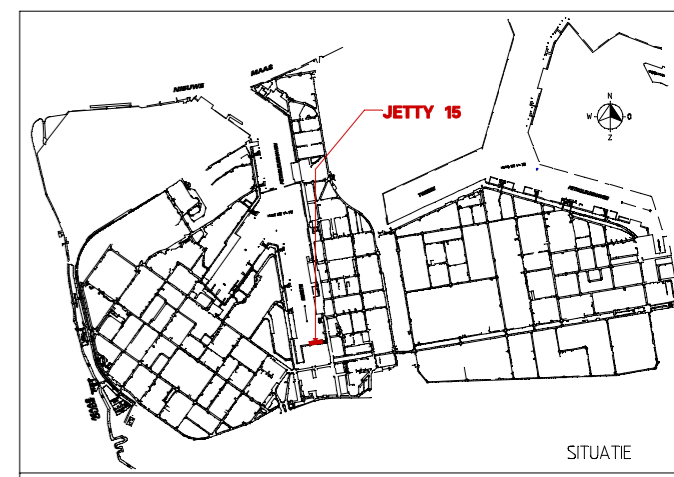

SITUATIE

REV.	DATE	DESCRIPTION	BUREAU	APP.

B	01-08-2016	OPNIEUW GETEKEND	DMS	746
REP 3182010 GEN. INSTRUMENTATION	plant	SCALE	A1	format
REP 3182010 GEN. ELECTRICAL	unit	SCALE	A1	format

**MOORING PLAN JETTY 15
FOR VESSELS OF 90m LENGTH**

reference	drawing	R-0415000	SHEET 1	of 1	REVISE

Shell Nederland Raff./Chemie b.v.

